

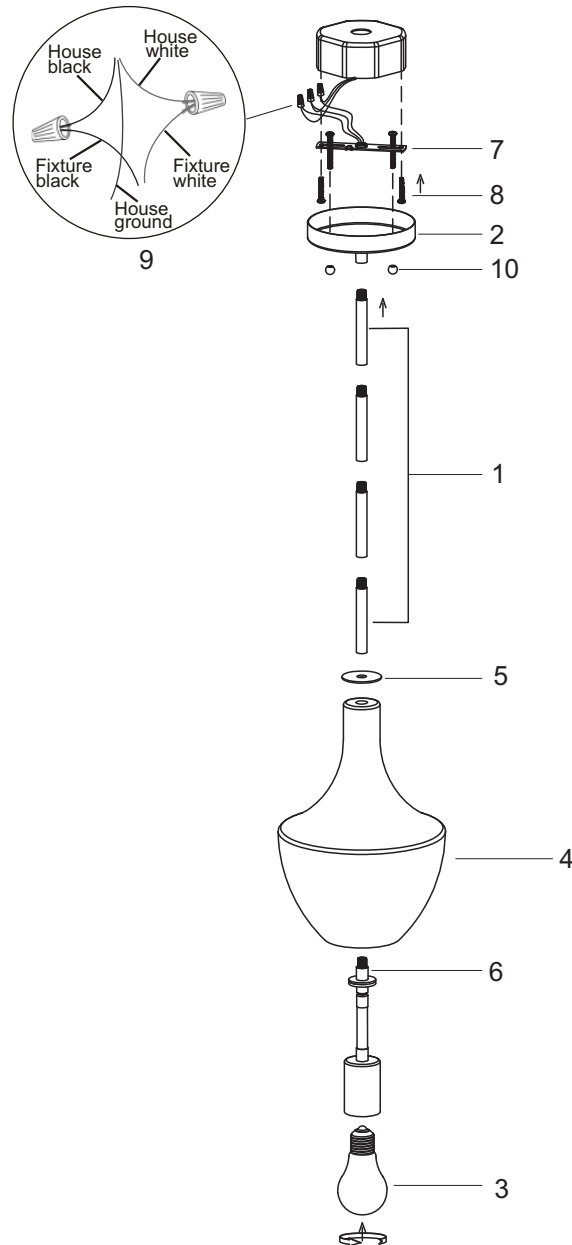

C47101 C47102



INSTALLATION INSTRUCTIONS:

- Ensure main supply is switched off.
- Connect poles (1), and fit one end of pole to ceiling plate (2).
- Fit lamp (3) firmly into lampholder.
- Fix shade (4), washer (5) onto the other end of pole with nipple (6).
- Fit crossbar (7) onto outlet box with self-tapping screws (8).
- Connect wires (9) according to color (White to White, Black to Black). Connect all earth lug together onto the crossbar with green screw to tight.
- Fit ceiling plate onto crossbar with nuts (10).
- Reconnect power.

WARNING:

- This fitting must be earthed.
- Disconnect power and allow fitting to cool down before cleaning or changing the lamp.